

A	B	C	D	
1	F57-1034	2346	449	1/2
2	F57-1035	2346	449	1/2
3	F57-2042	500	450	2/2
4	F57-2043	500	450	2/2
5	F57-3063	462	448	2/2
6	F57-3064	462	428	2/2
7	F57-9313	1732	471	1/2
8	F57-9315	616	471	1/2

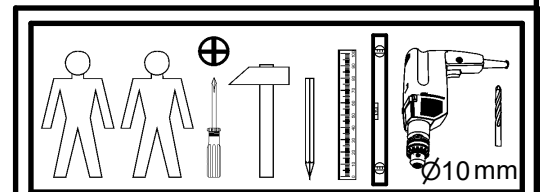

4x K0, Ø35 a204	4x Ø2 b90	4x d20	4x Ø6,3x10 mm e50	8x Ø8x30 mm f1	1x L360x60 g76/2	2x M4x25 mm j53	4x k75/3	12x l2
8x Ø3,5x15 mm p51	8x Ø15x12 mm #16 r1	8x Ø20x12 mm #16 r36	8x 6,7/7,8 r37	8x 20/11 r42	4x Ø12xM10x17mm r66	8x Ø16 s2	4x Ø12x4 mm s41	1x 4 mm z15
					1x 86x21x15/1,5 n14/2	2x Ø3,5x16 mm p38	1x Ø5x60 mm p17	1x Ø10x50 mm f35

1 

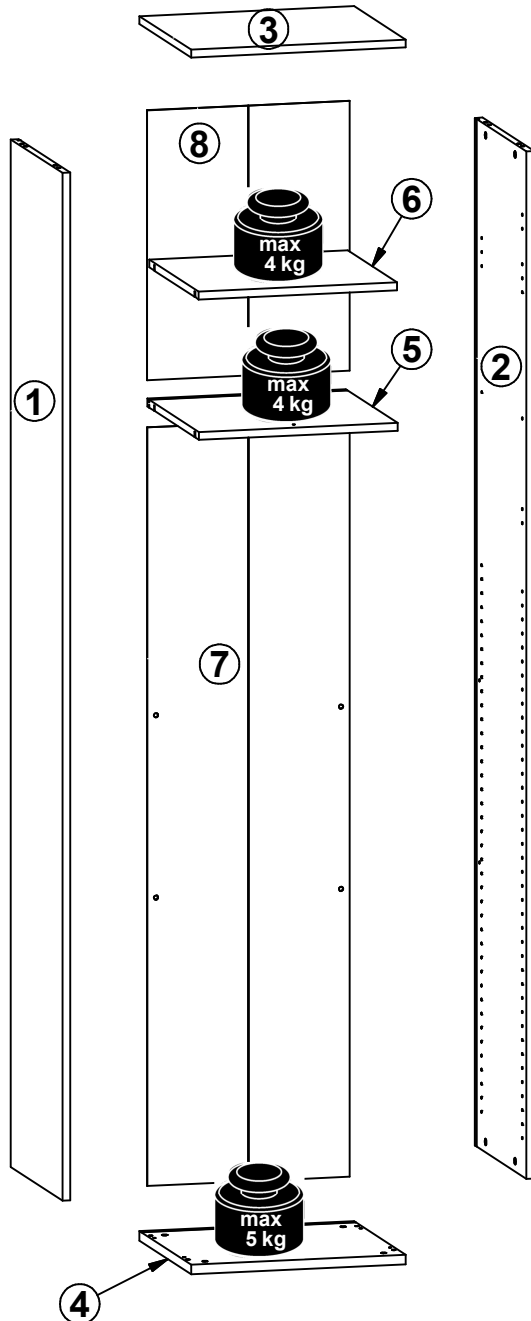
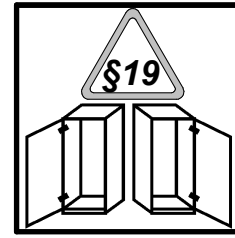
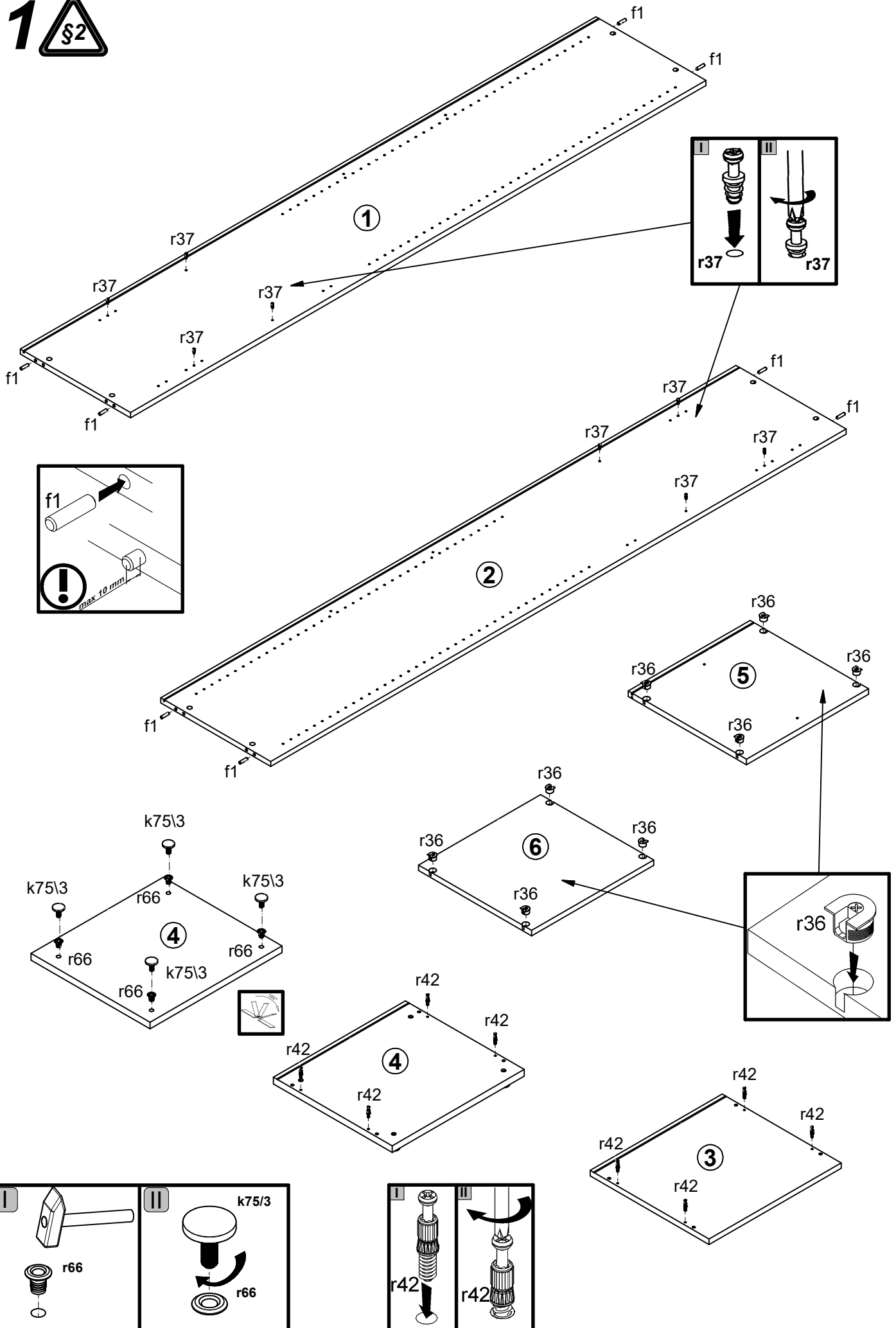

3 §6

I

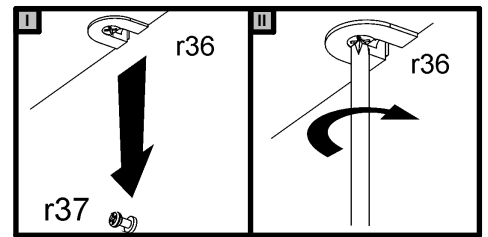
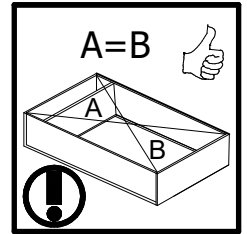
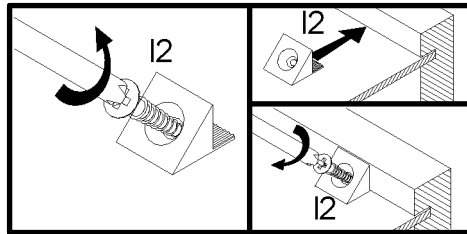
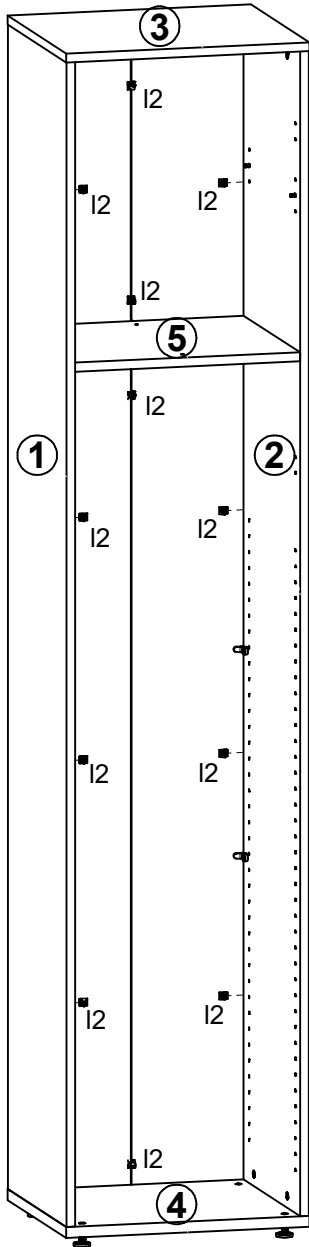

II

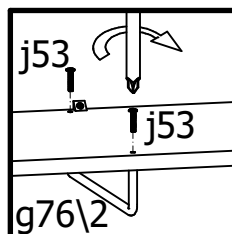
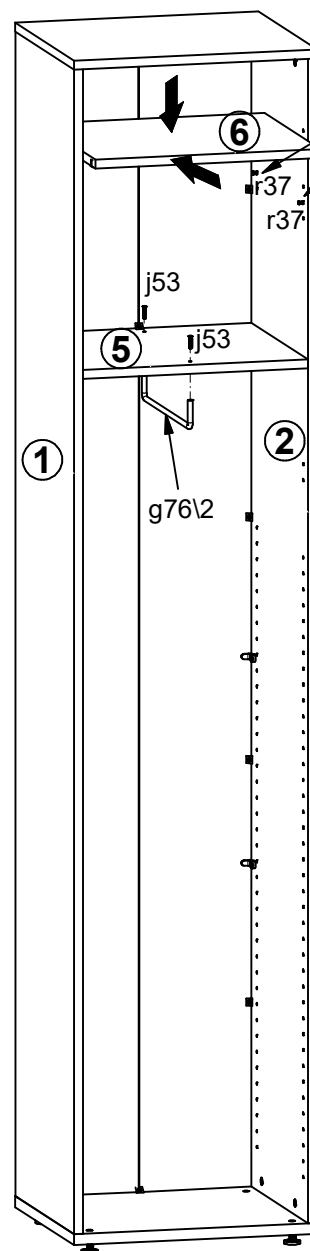

4A

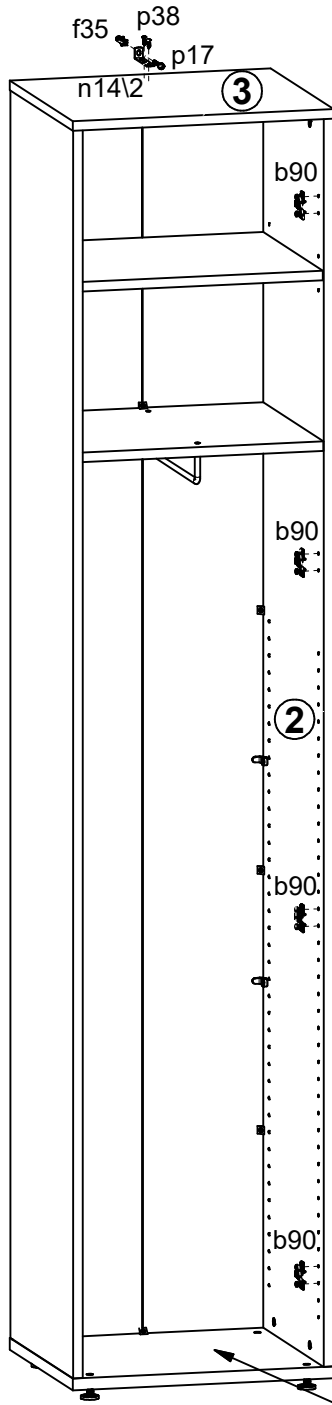

4B

