

BLUES

872

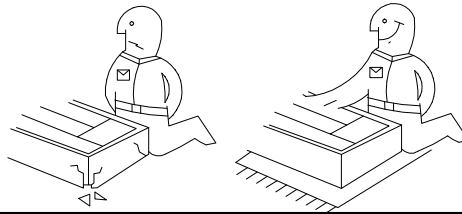
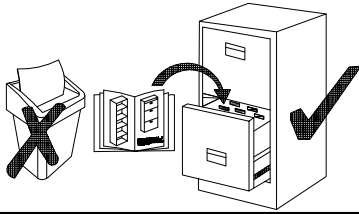
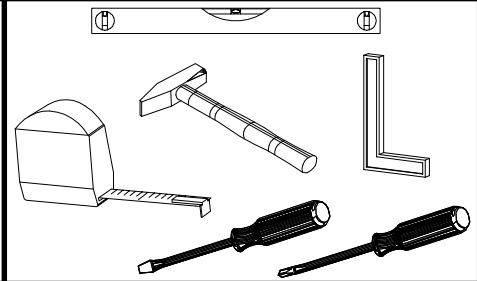

- Blues BJ01
- Blues SO01
- Blues WH01

Coli	Ersatzteil Nummer	Dimension	Coli	Ersatzteil Nummer	Dimension
1/2	BES.103	808x384x15	2/2	BES.402 x2	520x361x15
	BES.104	808x384x15		BES.604 x2	817x531x2,5
	BES.204 x2	1536x402x15		BES.605	817x448x2,5
	BES.302	433x347x15		BES.701	539x140x15
	BES.503	808x362x15		BES.704	539x373x15
	BES.504	808x362x15		BES.705	539x140x15
	BES.606	412x326x2,5		BES.706	539x373x15
	BES.902	330x100x12		BES.707	446x659x15
	BES.903	330x100x12		BES.708	446x140x15
BES.904	402x100x12	BES.801 x2	330x538x4		

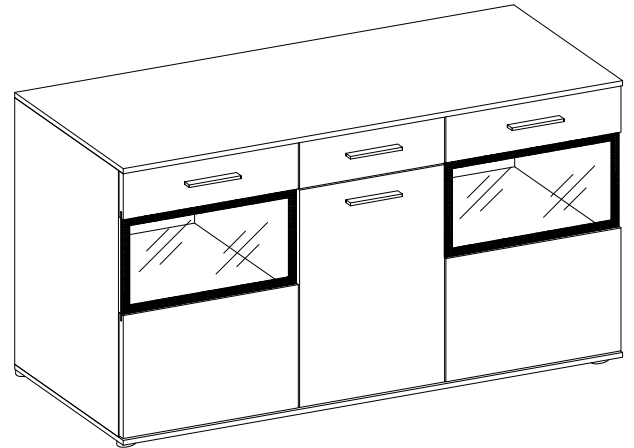

					L2	
					10	
					G1	L9
			2	1		
					R2	S11
			8	4	1	
					P14	F10
			6	6	2	2
					P7	M2
			16	4	1	4
					I4	J3
						L
			24	30	24	24
			6	8	17	1
						O11

ISM-BES-02

1

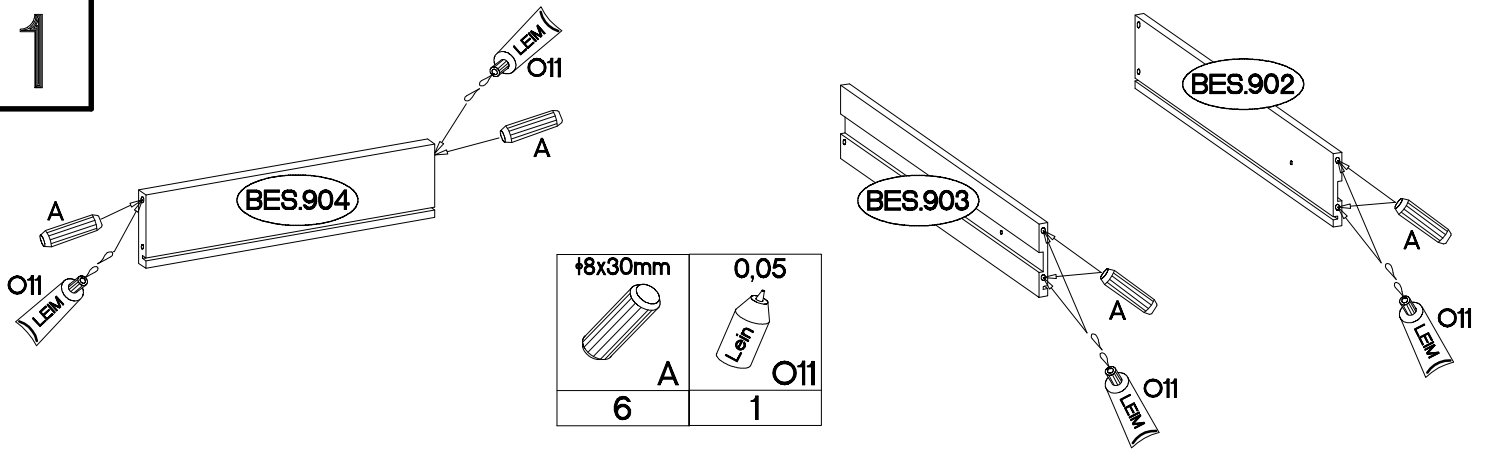

2

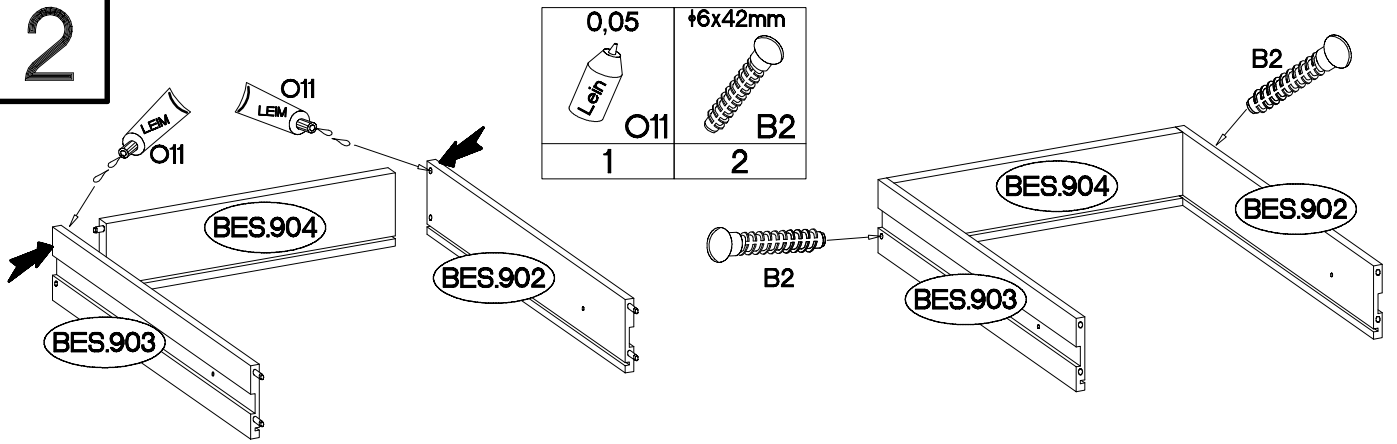

3

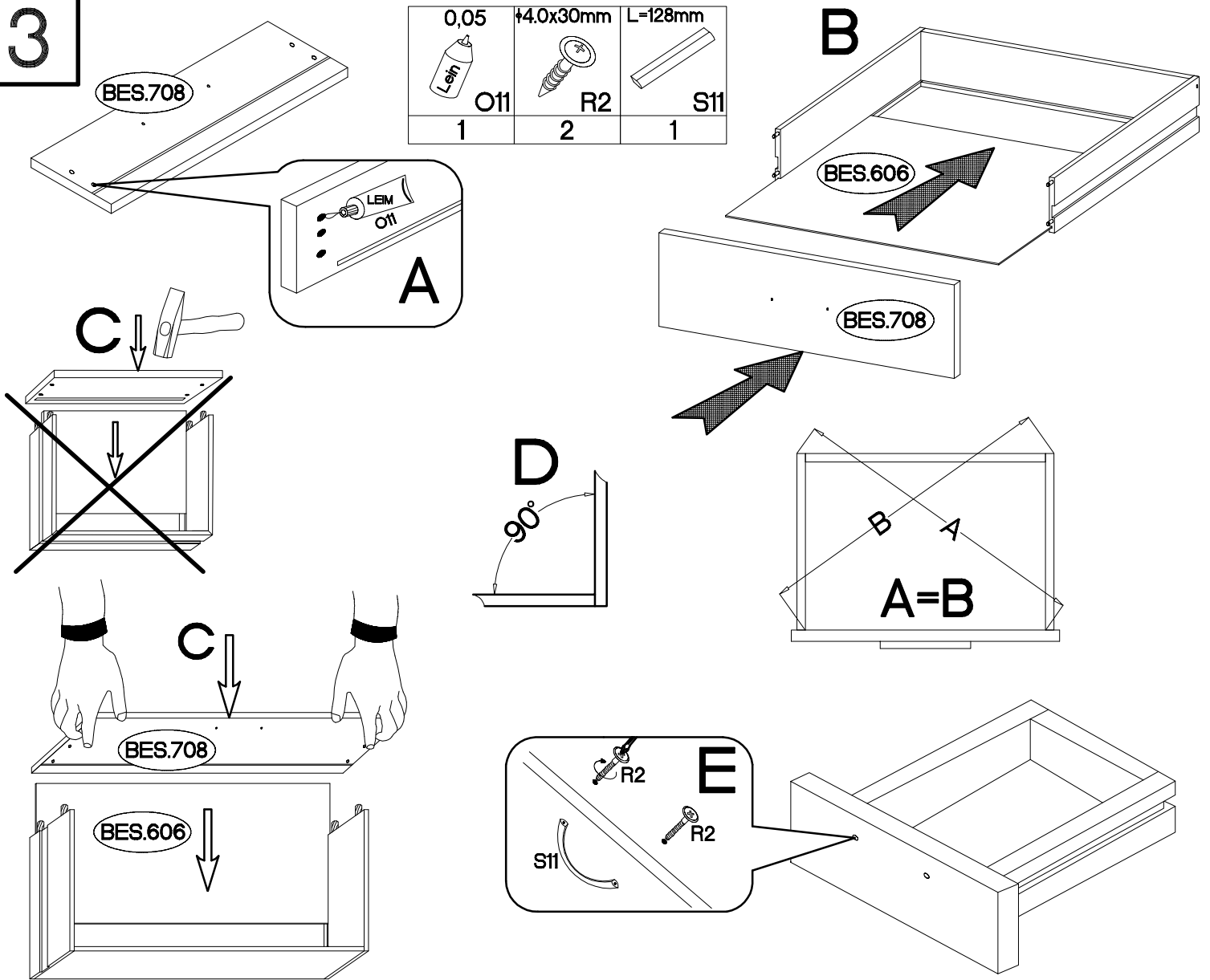

±15/12mm	±8x30mm	L=20mm	±4.0x25mm		±6,3x13mm	27/310mm
					<td> </td>	
C	A	D2	P14	F10	M2	I4
24	24	24	6	6	4	1

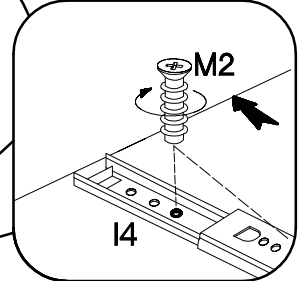
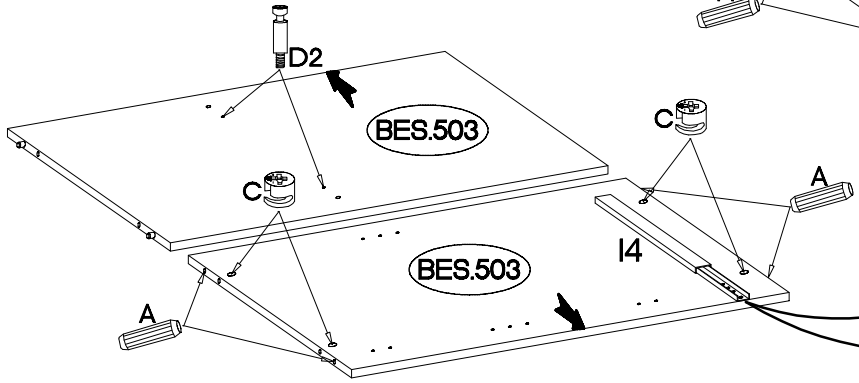
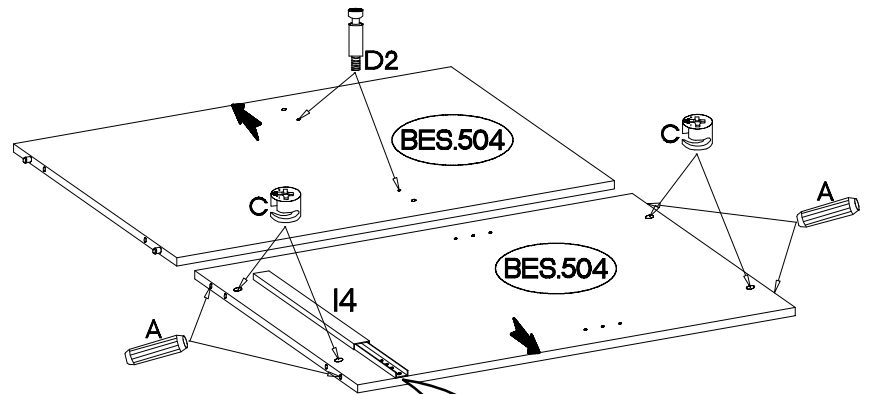
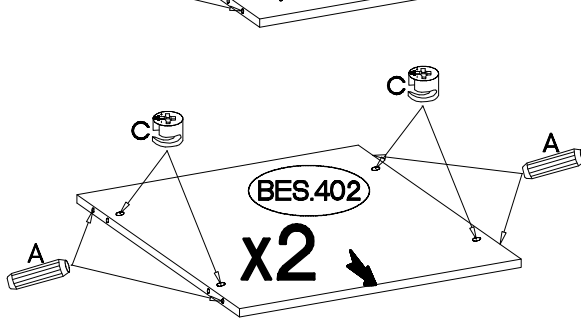
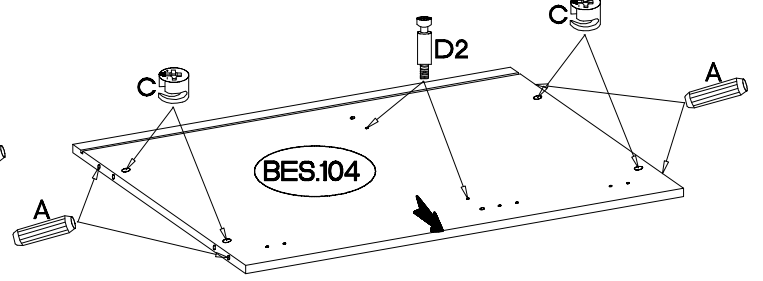
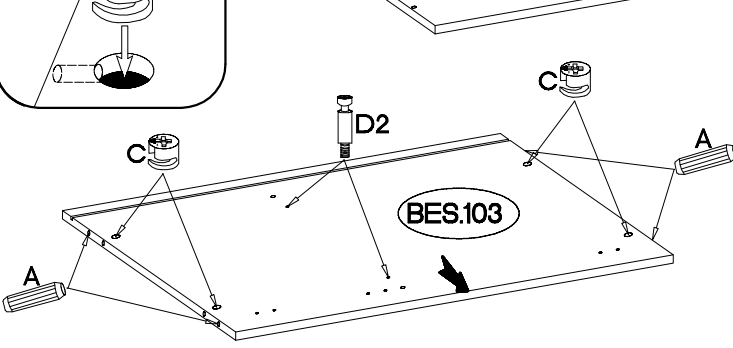
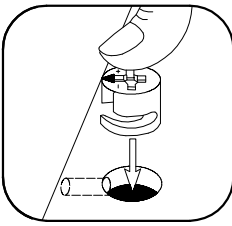
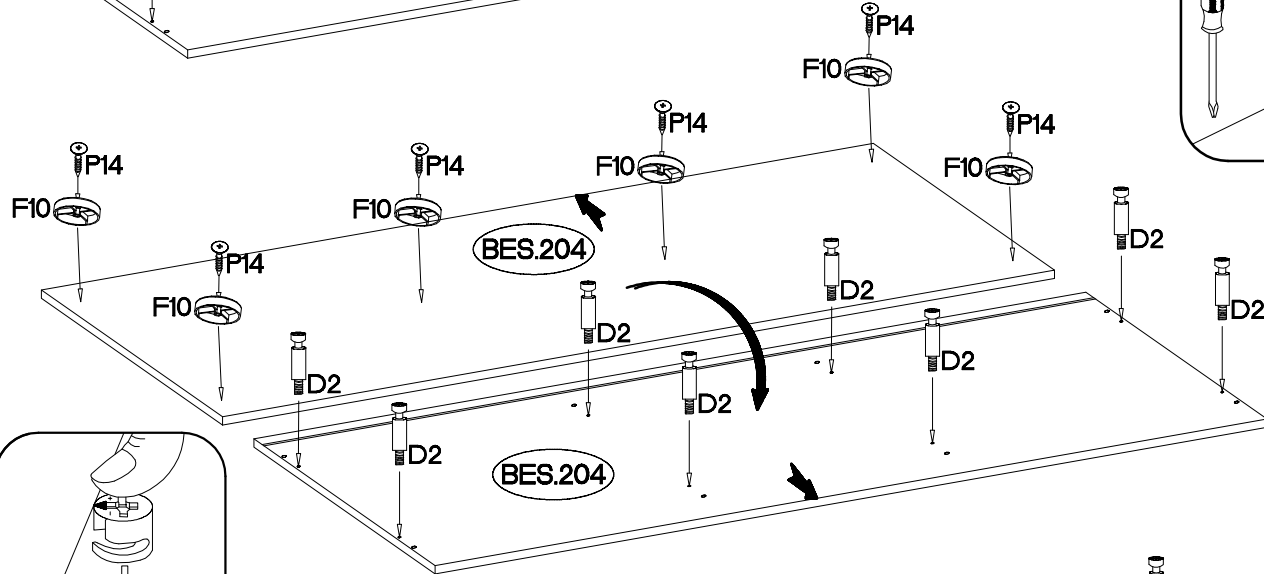
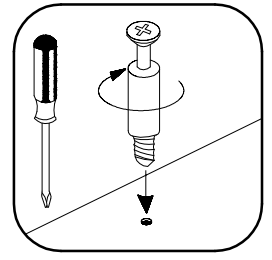
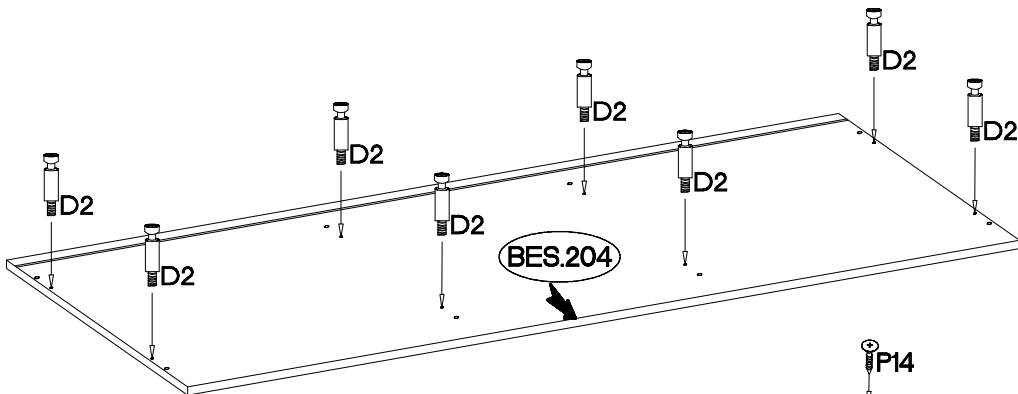
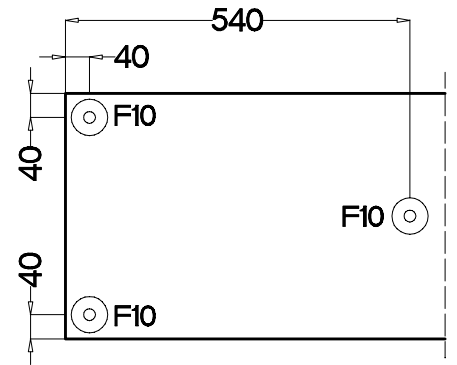

5

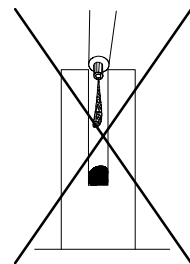
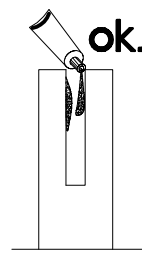
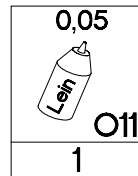
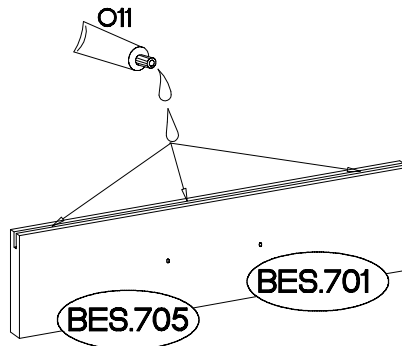
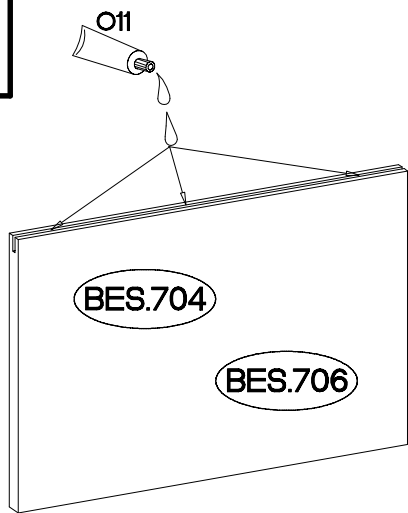

6

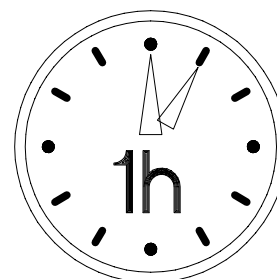
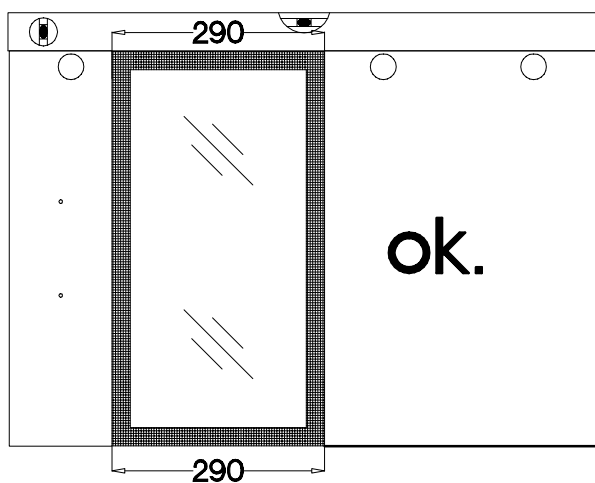
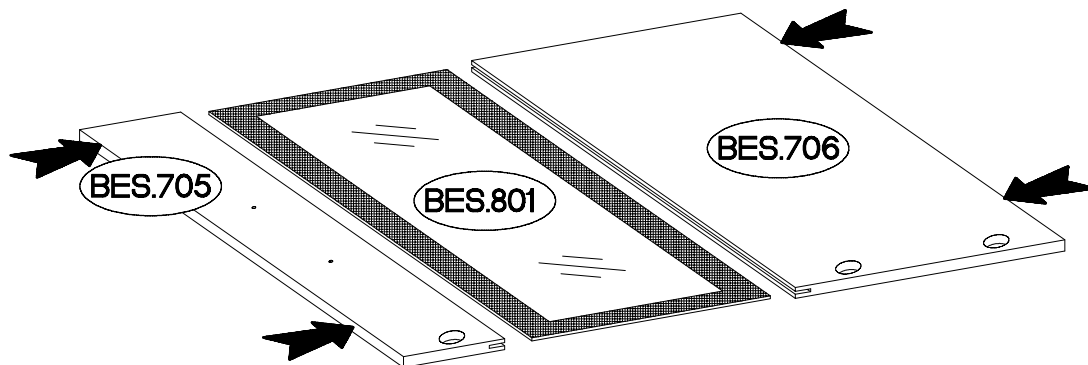
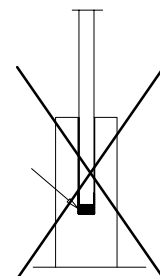
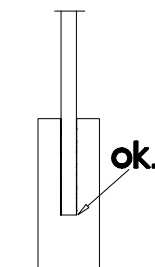
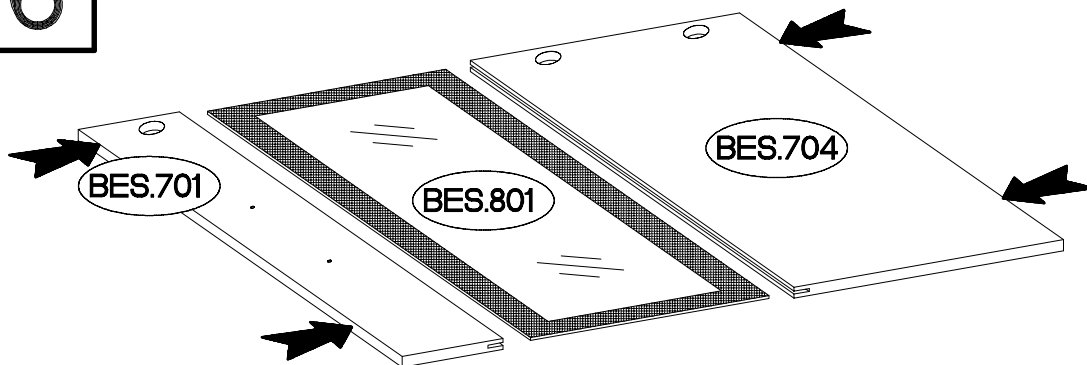

7

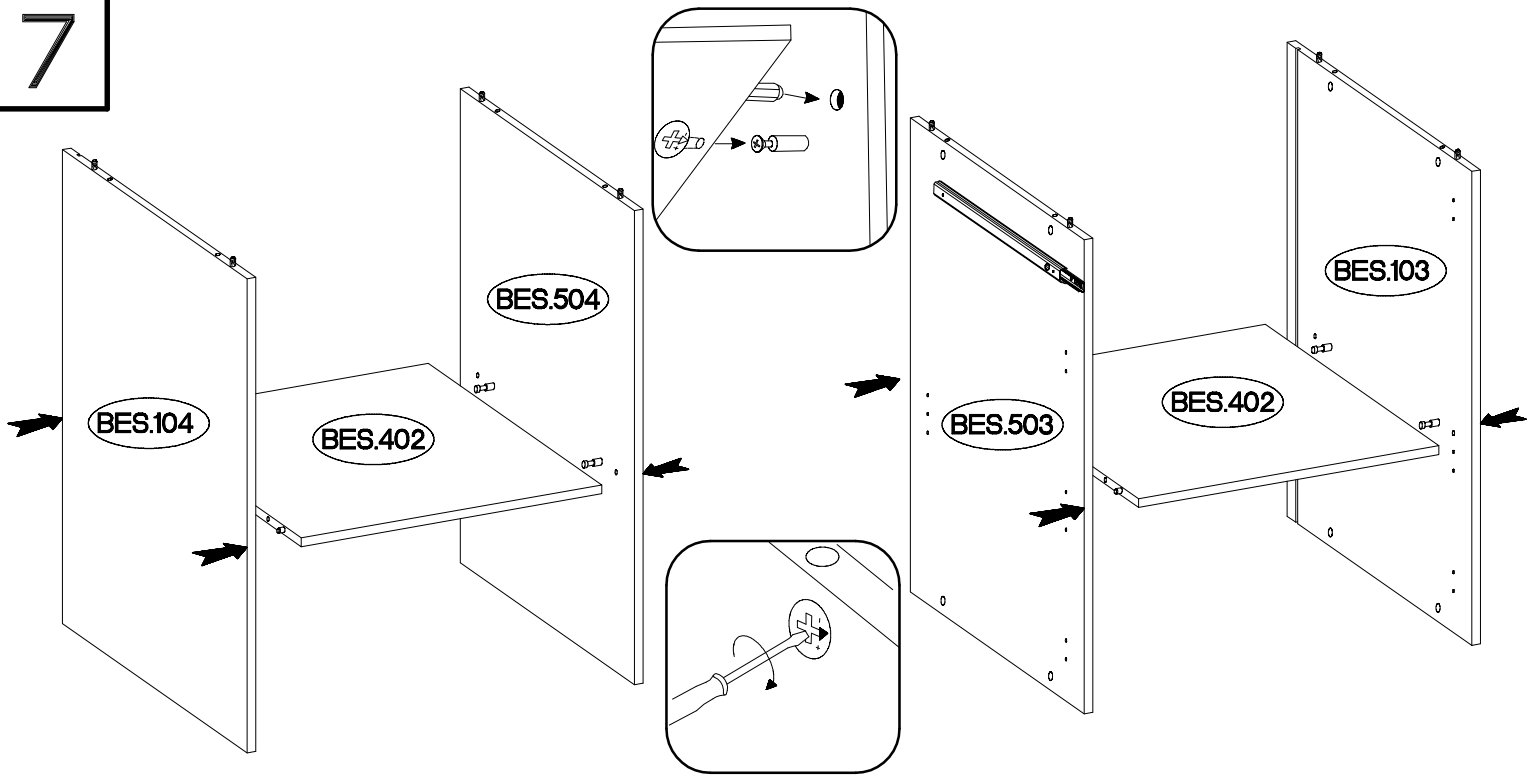

8

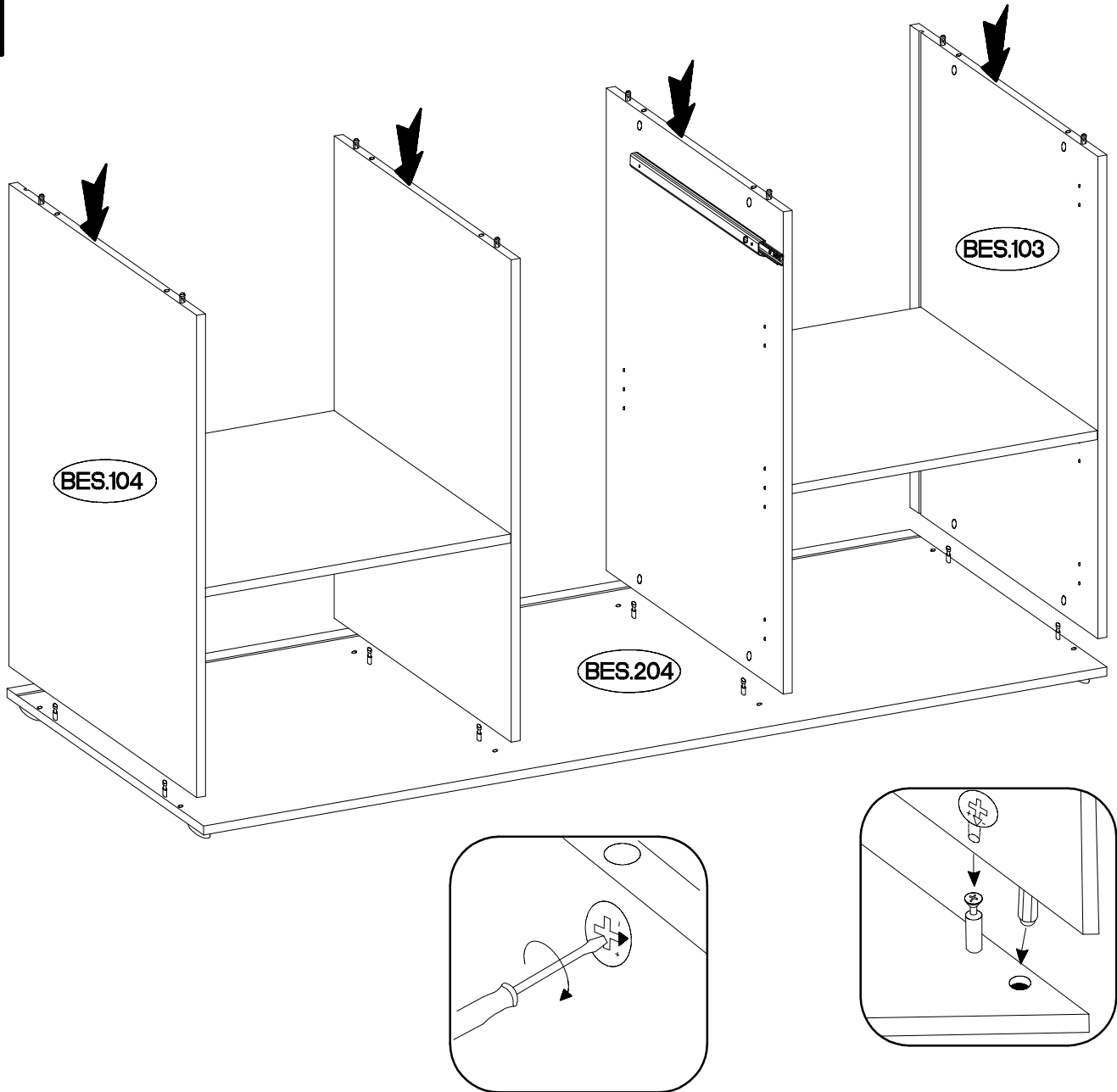

9

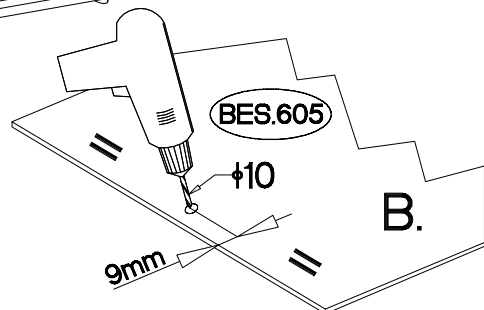
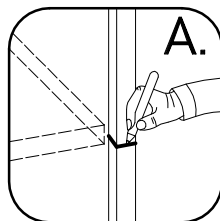
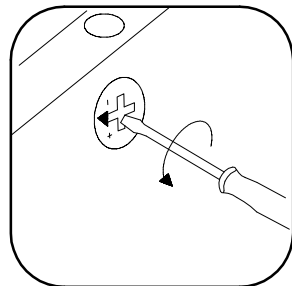
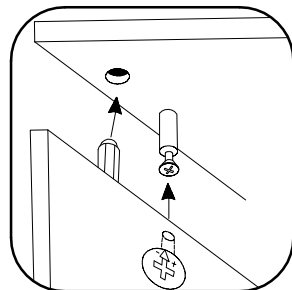
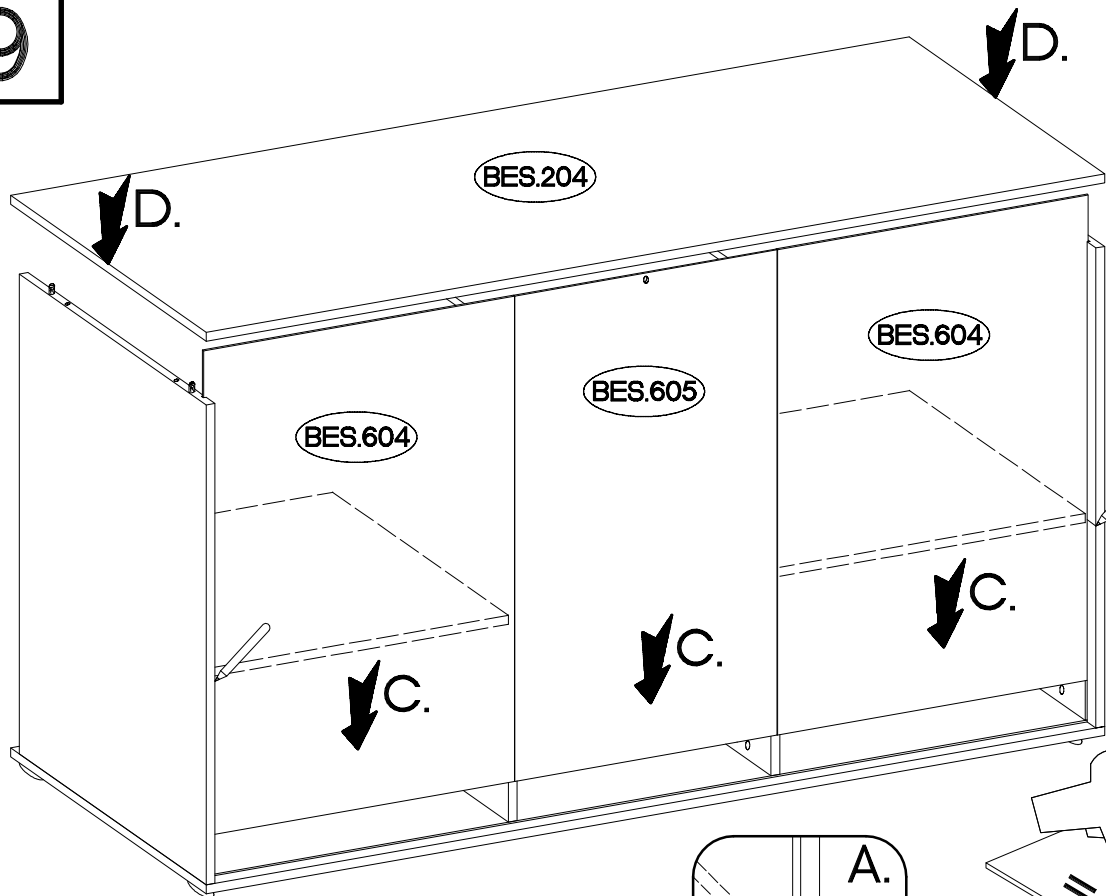

10

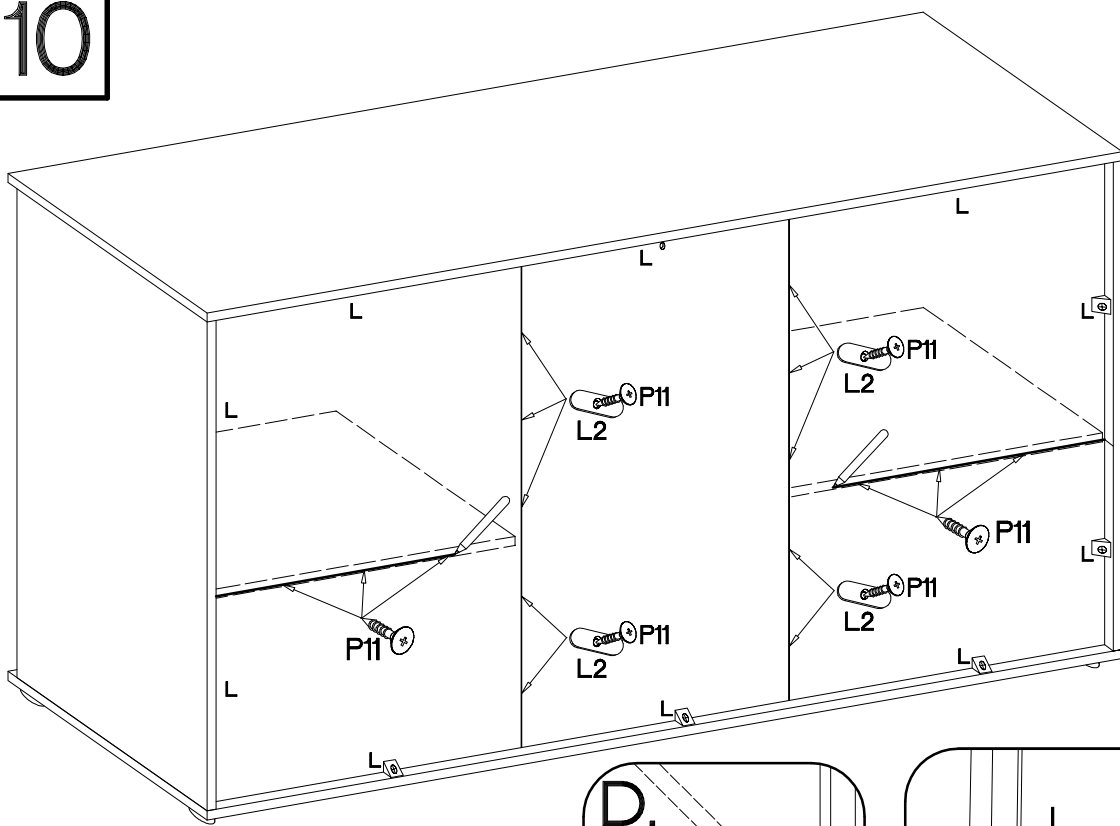

$\varnothing 3.0 \times 20 \text{mm}$		
P7	L2	L
16	10	10

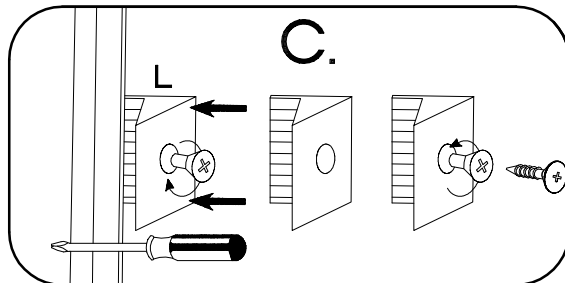
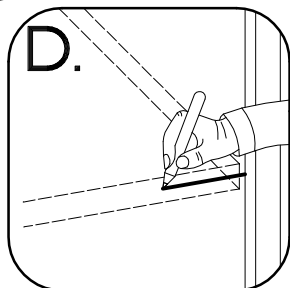
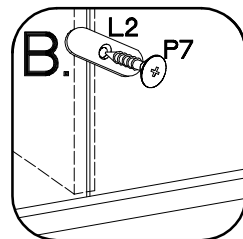
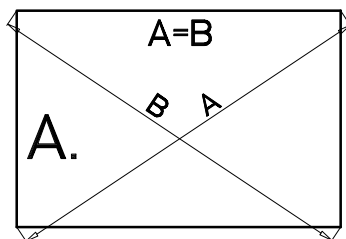

11

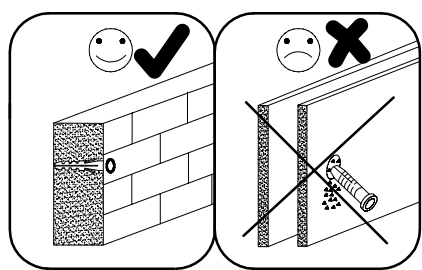
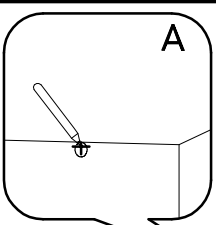

	$\pm 3.5 \times 13 \text{mm}$
L9	P5
1	1
	$\pm 10 \times 50 \text{mm}$
	O7
	1

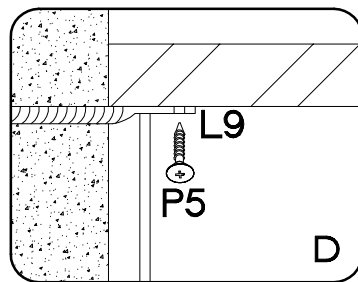
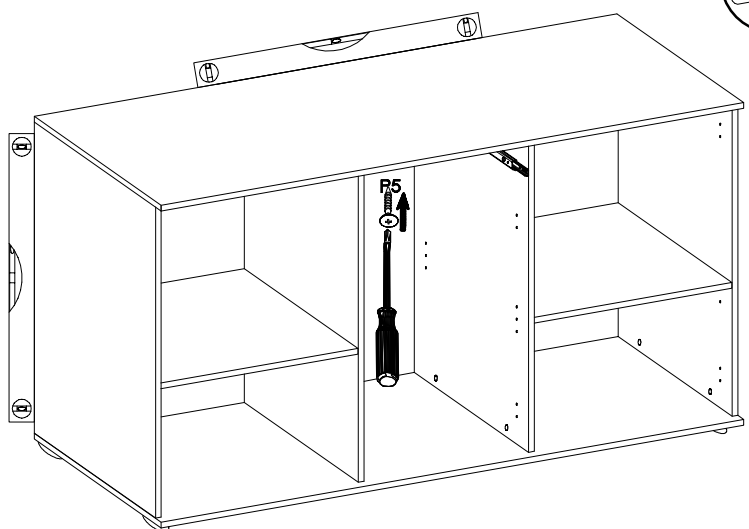
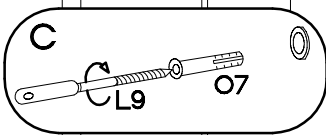
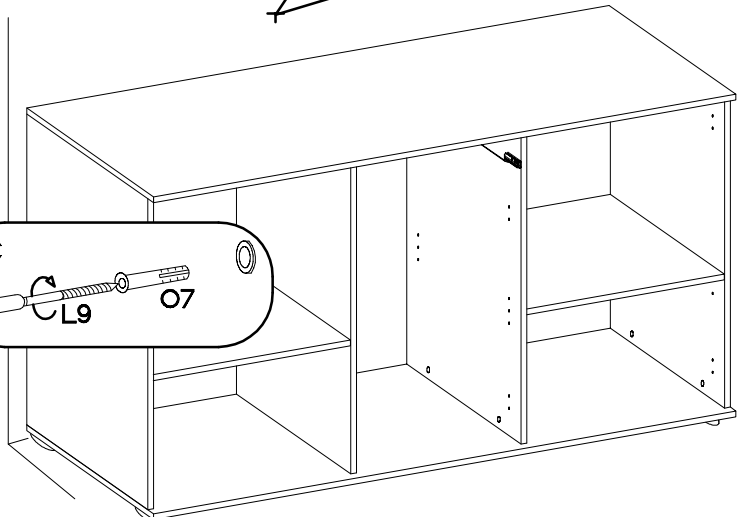
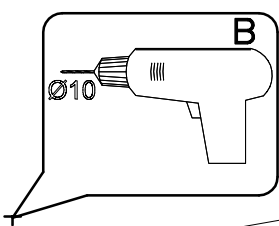
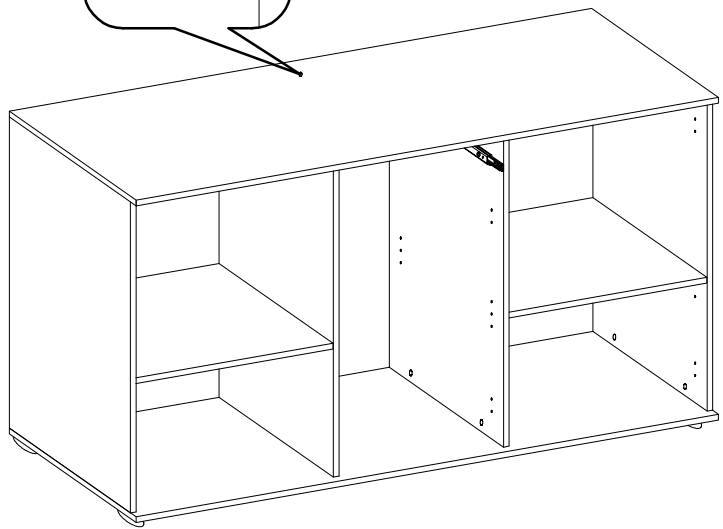

12

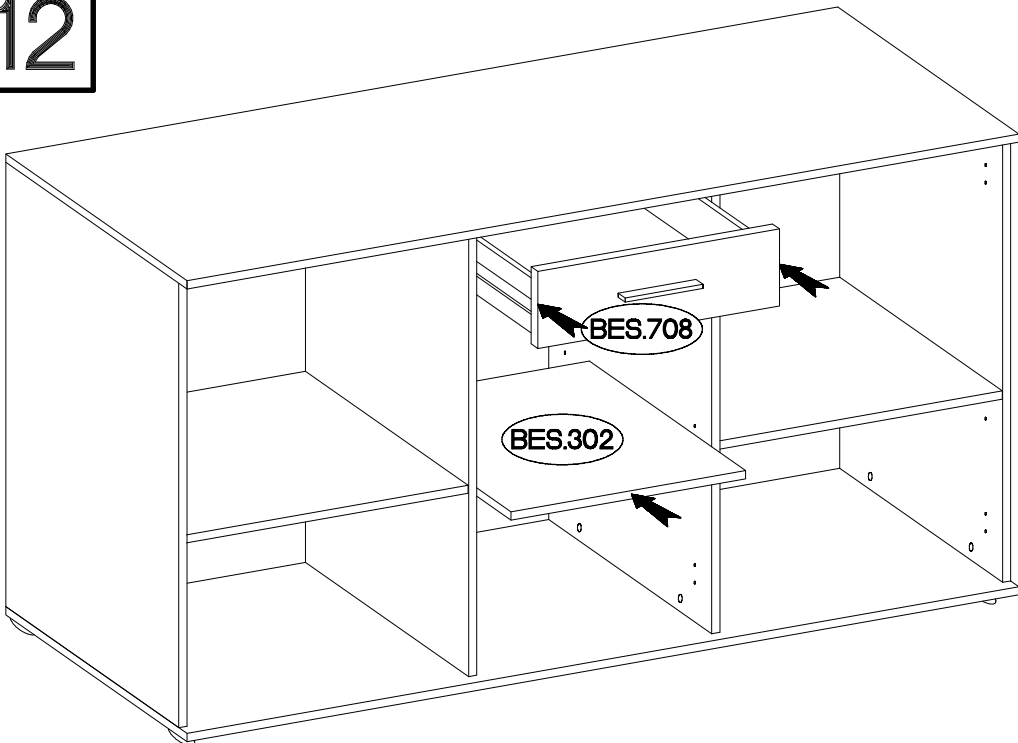

		M4x9mm
E	J3	U1
24	4	2

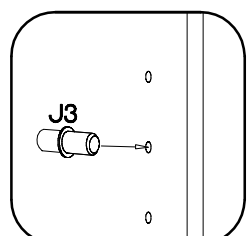
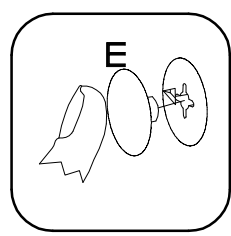
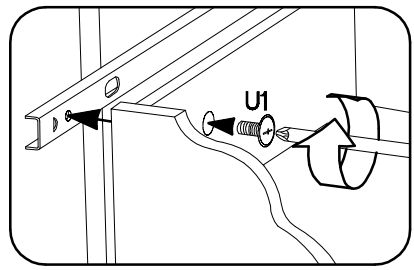

13

+35/9mm	+35/0mm	H=0	+3.5x13mm
G1	G	H	P5
2	6	8	16

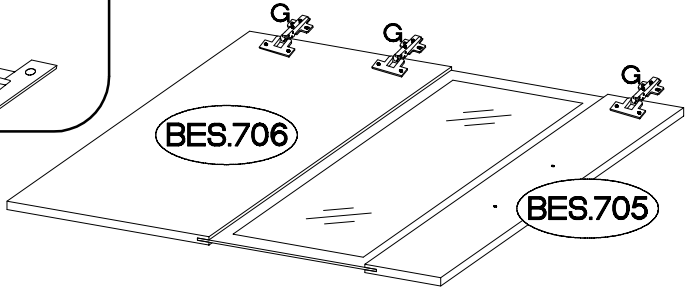
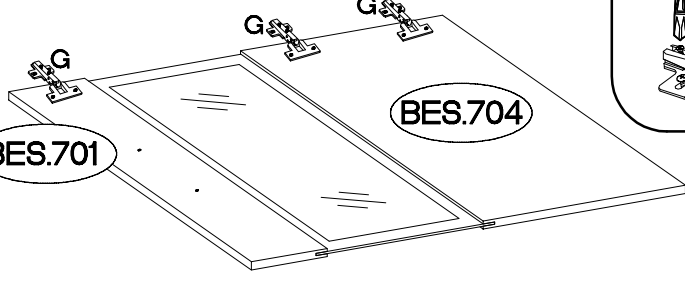
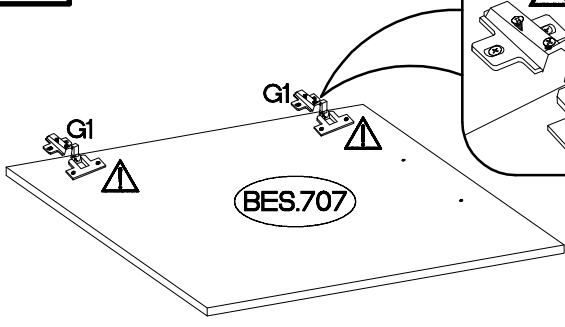
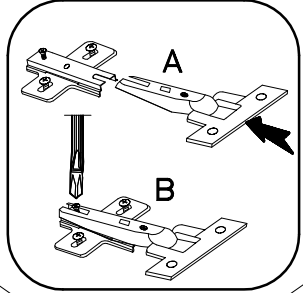
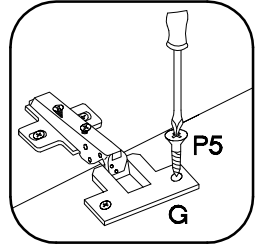
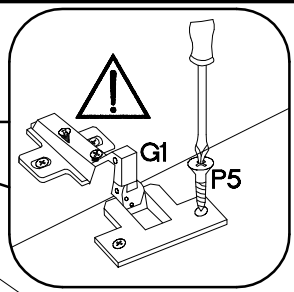

14

+4.0x30mm	L=128mm
R2	S11
6	3

