

Modellname:
Nazwa modelu:

DOVER

Modellreihe:
Numer modelu:

SL -- 08

Type:
Typ:

Blatt Nr **1** von: **3**
Strona z:

MONTAGEANLEITUNG INSTRUKCJA MONTAŻOWA



2 Personen
2 Osoby

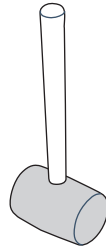
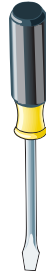
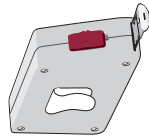

MONTOWAĆ
NA ROZŁOŻONYM KARTONIE!

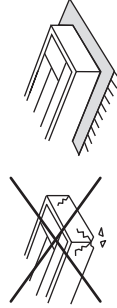

Wskazówka dotycząca
pielęgnacji!

Proszę czyścić tylko suchą
lub lekko wilgotną szmatką do kurzu.
Nie używać żadnych środków szorstkich!
Maksymalne obciążenie półek w kg:

Stärke/Gr.	Spanplatte/Płyta		
Länge/Dł. [mm]	15	18	22
0 < 400			
401 < 600	40	40	40
601 < 800	24		
801 < 1000	15	30	

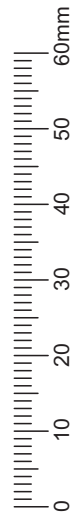
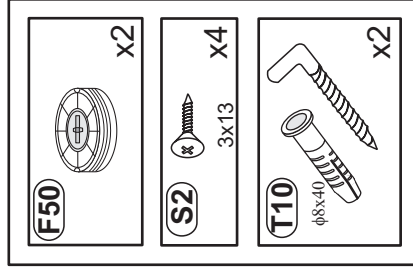
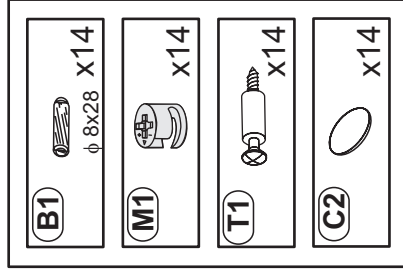
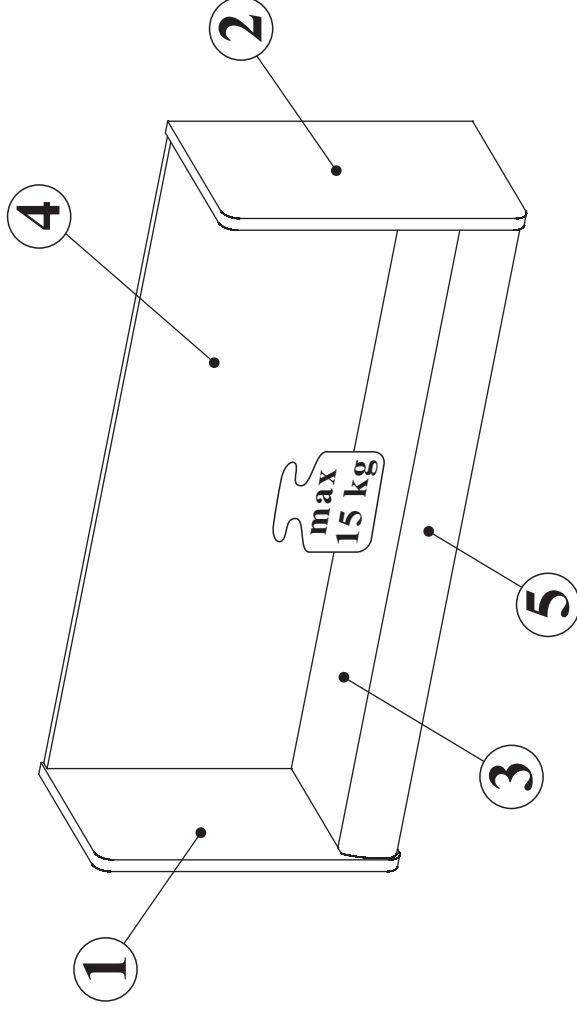

Modelname: **DOVER**
Nazwa modelu:

Modellreihe:
Numer modelu:

SL--08

Type: **01**
Typ:

Blatt Nr **2** von: **3**
Strona z:

1

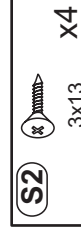
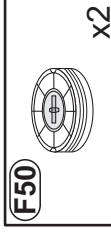
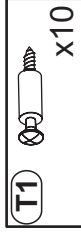
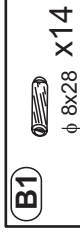
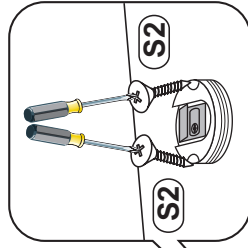
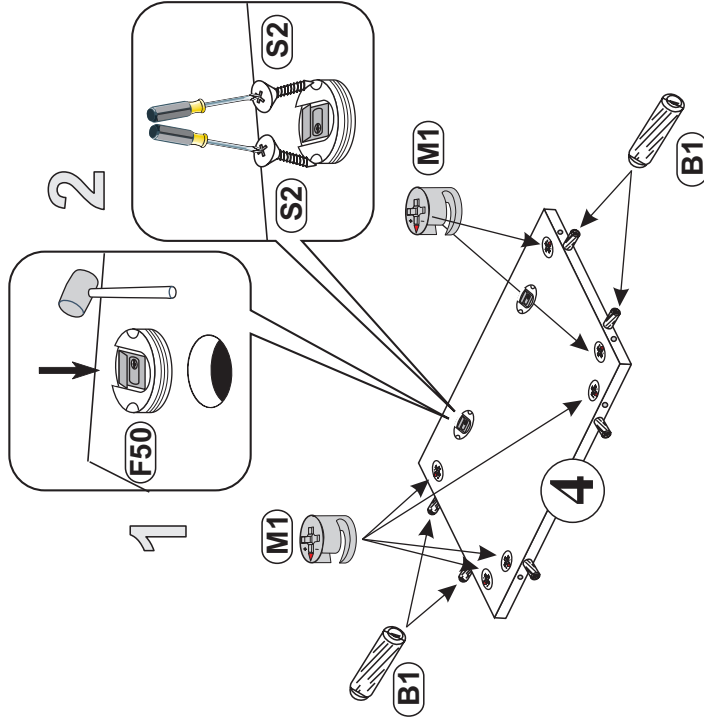
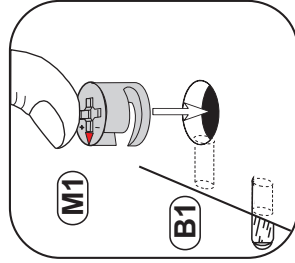
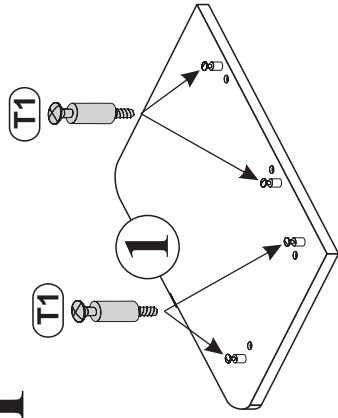

2

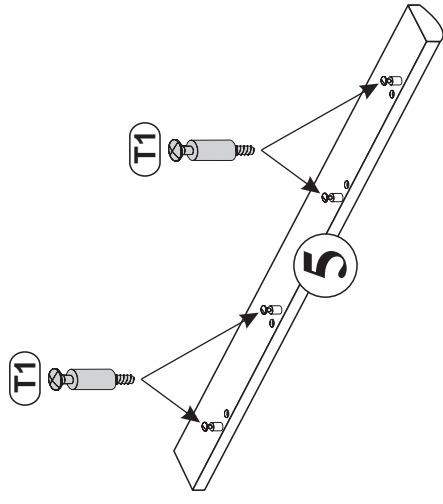

3

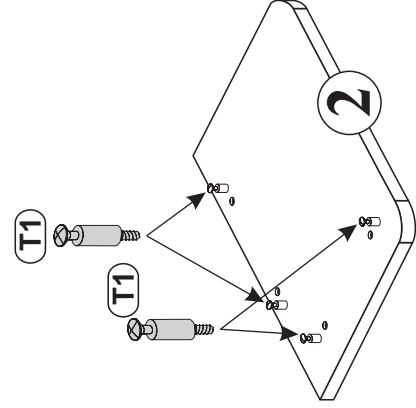
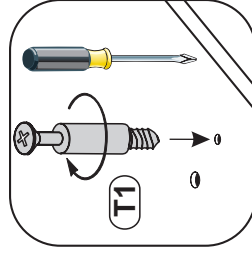
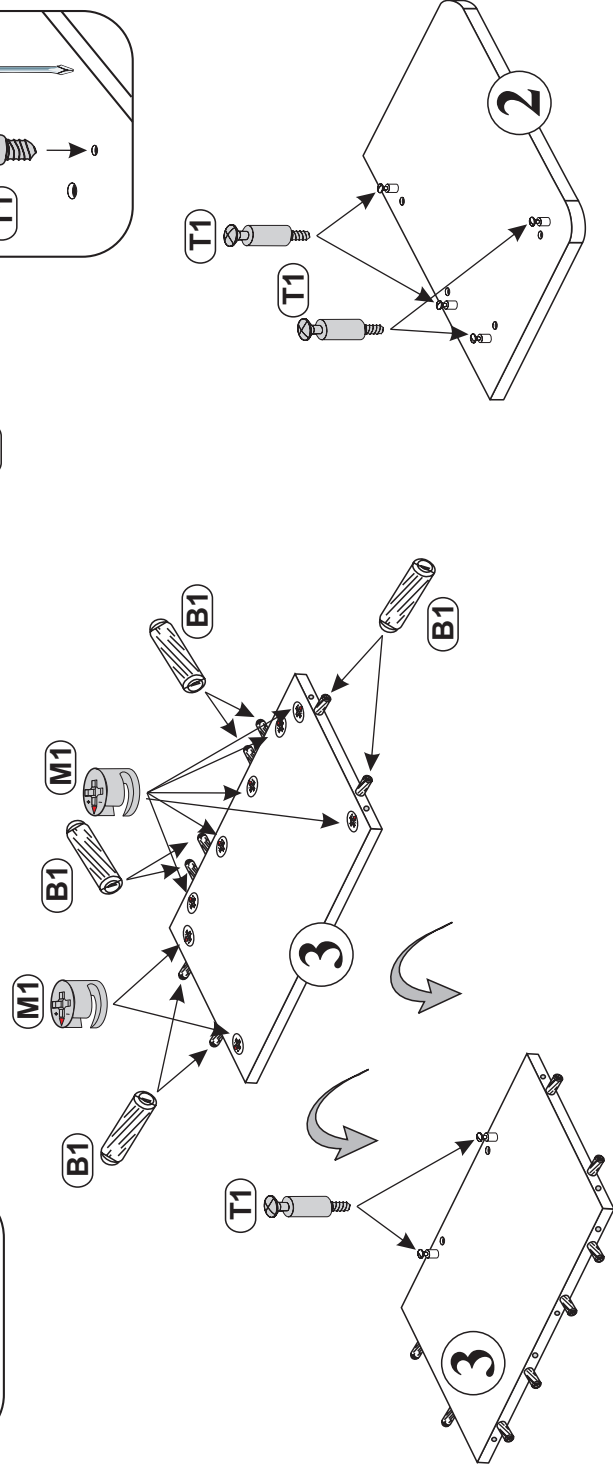

Modelname: **DOVER**
Nazwa modelu:

Modellreihe:
Numer modelu:

SL -- 08

Type: **01**
Typ:

Blatt Nr **3** von: **3**
Strona z:

