

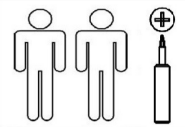

D - Montageanleitung GB - Assembly instructions NL - Handleiding voor de montage
 PL - Instrukcja montażu TR - Montaj talimatı RU - Инструкция по монтажу
 RO - Instrucțiuni de montaj IT - Istruzioni di montaggio FR - Notice de montage
 SK - Návod na montáž CZ - Montážní návod HU - Szerelési útmutató



1/1

LONE 2F.RECBK
LONE RECBK.2F



H=50 UP
 M5x35
E x6 **A** x6

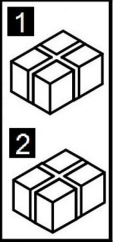
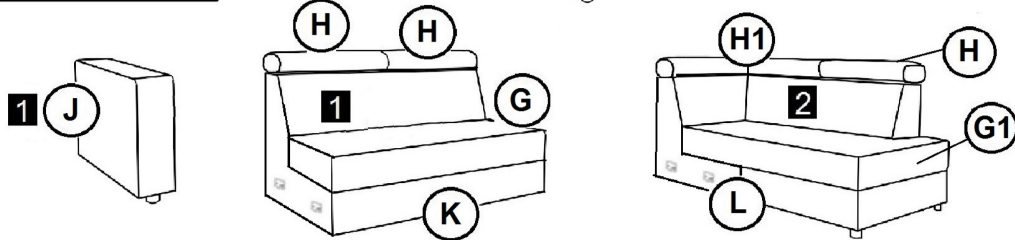

2F.RECBK

RECBK.2F

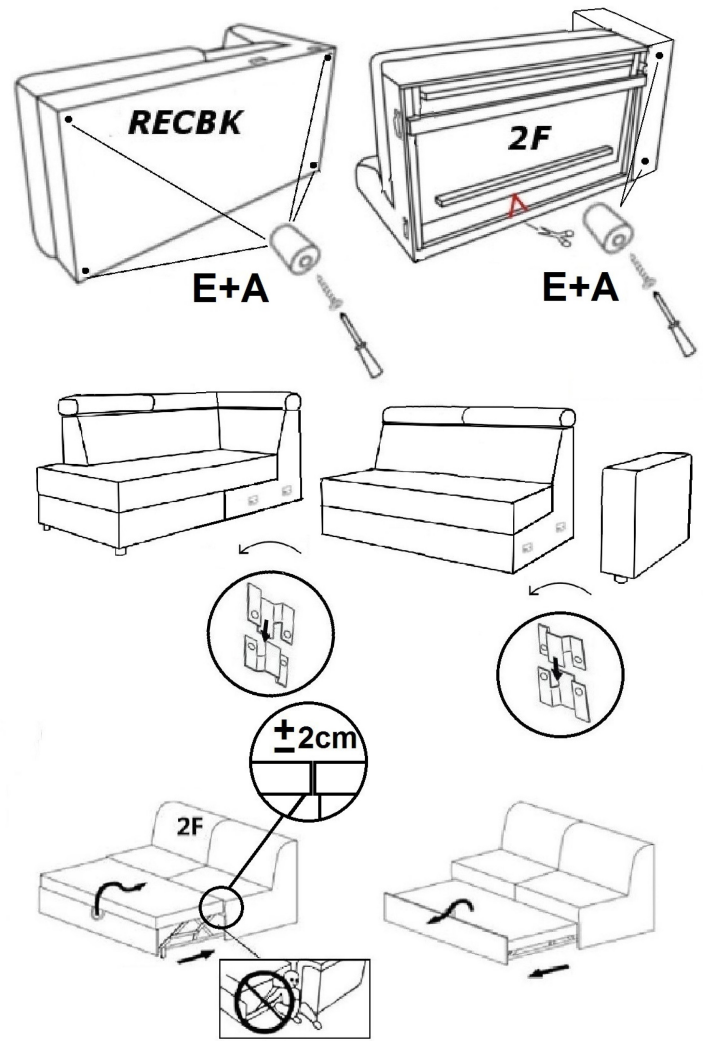
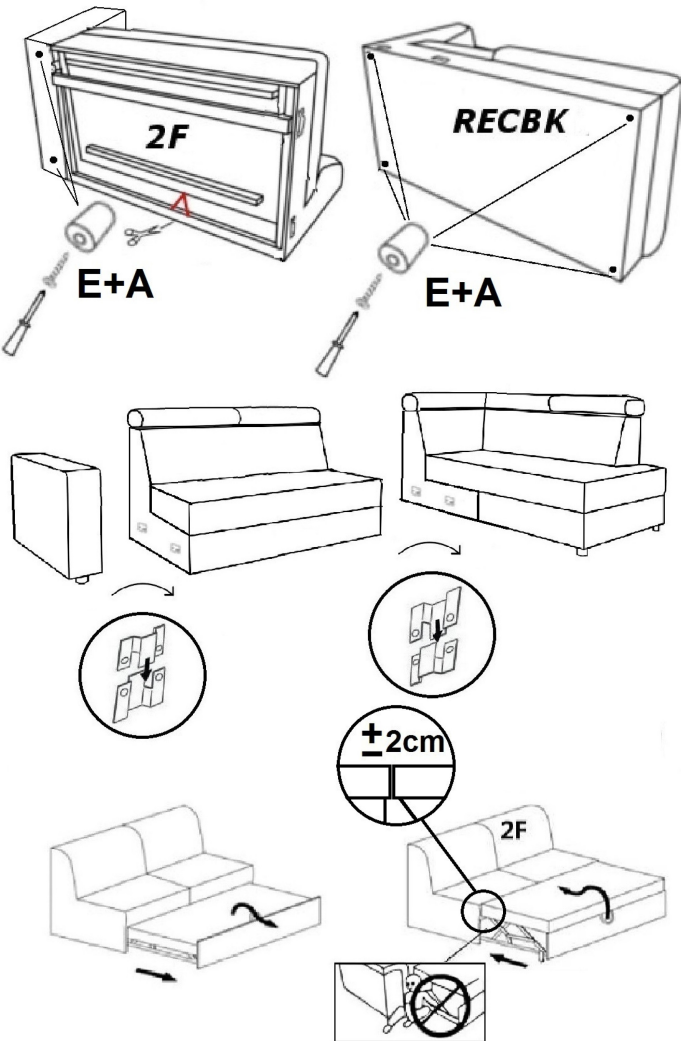

Service-Dienstverlening-Serwis-Servis-Сервисная служба-Assistenza-Szerviz

Typ-Type-Tip-Tipus-Tipus <small>002</small>		
E	K	
A	L	
J		
H		
H1		
G		
G1		

